

QDC6466K

High Power, High Isolation

Features:

- * High Power
- * High Isolation
- * Low Insertion Loss
- * Low VSWR

Applications:

- * Wireless
- * Radar
- * Laboratory Test

Description

QDC6466K series Drop-In Circulators cover frequency range 950~2000MHz. High power, high isolation and low insertion loss make it ideal for a lot of applications like amplifiers, transceivers, etc.

Specifications

Frequency (MHz)	Bandwidth (MHz)	Insertion Loss (dB Max.)	Isolation (dB Min.)	VSWR (Max.)	Average Power (W Max.)	Temperature (°C)
950~2000	1050	0.70	16.0	1.40	10~100	-10~+60
1000~2000	1000	0.60	17.0	1.40	10~100	-10~+60

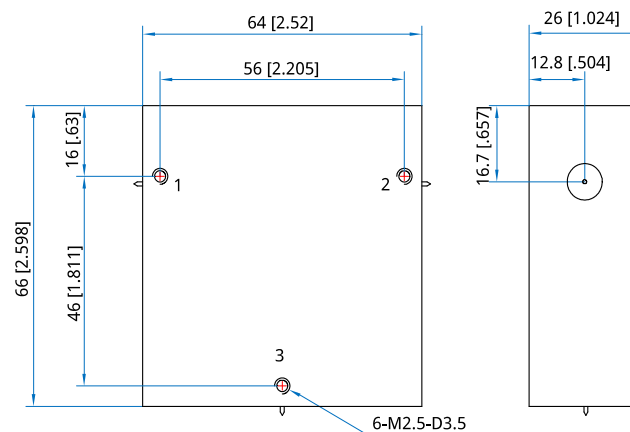
Outline Drawings

Unit: mm [inch] Tolerance: $\pm 0.2\text{mm}$ [$\pm 0.008\text{in}$]

Mechanical

Size ^{*1} :	64*66*26mm
	2.25*2.598*1.024in
Connector Type:	Strip line
Mounting:	6-M2.5, depth 3.5mm

[1] Exclude connectors

Direction Naming Rules:

- 1 - Clockwise
- 2 - Anticlockwise

How To Order
QDC6466K-W-X-Y-Z

W: Start frequency in MHz

X: Stop frequency in MHz

Y: Average Power in W

Z: Direction type

Examples:

To order a QDC6466K series Circulator, 950~2000MHz, 100W, Clockwise, specify QDC6466K-950-2000-K1-1.

Customization is available upon request.